

S  
I  
N  
G  
L  
E



**Friga**  
*Systems*



**Modular Refrigeration Units**

# Friga Systems

## Single Unit

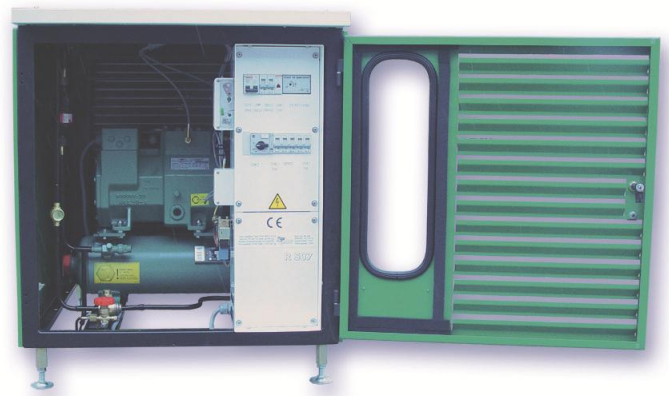

### STANDAARD UITVOERING:

- \* Weerbestendige omkasting
- \* Condensor met één 500mm ventilator [230V/1F/50Hz]
- \* Compressor [semi-hermetisch]
- \* Vloeistofvat [10dm<sup>3</sup>]
- \* Vloeistoffilter-droger en kijkglas
- \* Hoge en lage druk beveiliging pressostaten
- \* Koudemiddel intrek afsluiter
- \* Compleet leidingwerk en volledig getest onder druk
- \* Geïntegreerde elektrische schakelkast
- \* Volledig bedraad & getest
- \* PED /  gecertificeerd

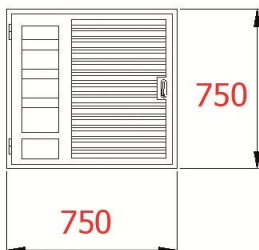
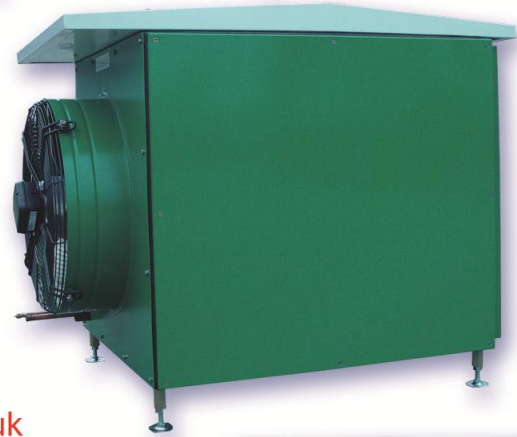

Front View

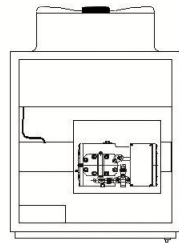

Bottom View

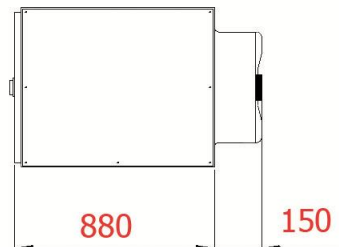

Side View

### Condensor Capaciteit(kW) met 1x 230V/1F/50Hz 500mm ventilator

Single Model	Nominaal Capaciteit 500mm ventilator				
Condensator	15K TV	6K TV	8K TV	10K TV	12K TV
FS**2S	7,73	3,09	4,13	5,15	6,19
FS**4S	13,28	5,31	7,08	8,86	10,63
FS**6S	16,56	6,62	8,83	11,04	13,24

